

Cascade

DRINKING WATER FILTRATION SYSTEM

Owner's Manual &
Installation Guide



42445 Avenida Alvarado, Temecula, CA 92590
800-451-9343 www.nimbuswater.com

Please fill out this form immediately after installation and retain for future reference.	
Model Number	NS-14-__ __
Code	__ __ __ __ __ (On right side of frame below model number)
Install Date	
Service Phone	

Cascade Introduction to the Cascade Drinking Water System

Congratulations on your purchase of the Cascade Drinking Water System. When properly maintained, this system will provide you with years of trouble-free service. The next three sections contain important information on the proper care and maintenance of your system, please take a few minutes to read through this information.

The cartridges in this system must be replaced on a regular basis to maintain efficiency and to ensure high water quality. These cartridges work together and must be replaced every 6-12 months. Any significant change in performance of the system should be investigated promptly to avoid secondary damage or deterioration to other parts of the system.

CAUTION: Improperly installed systems could result in water damage due to leaks or flooding. Proper installation of this system requires familiarity with standard sink plumbing and proper use of common hand and power tools. If you are not familiar with standard sink plumbing and proper use of common hand and power tools or have any difficulty with the installation of this system, consult a licensed professional, such as a contractor or plumber.

NOTE: This system has been designed for installation by licensed professionals, such as a contractor or plumber.

Component	Cap Color	Indications	Replacement Interval
25 Micron Sediment Filter	Green	Water production slows	6-12 months
Granular Activated Carbon GAC Filters (2)	Blue	Odors, including chlorine smell, in the product water.	6-12 months



System Performance

System Capability	1700 gallons
Sediment Filter	25 micron
GAC Carbon Filters (2)	20 micron
Manifold dimensions	12.5"W x 15"H x 4.5"D
Manifold weight (dry)	6.25 lbs.

Feed Water Requirements

Feed water	Potable, municipal water
Feed pressure	40 - 80 psi
Feed temperature	40° - 100°F
Chlorine	<1.0 mg/L
Turbidity	<1 NTU
SDI	<5
pH	4-8

Do not use with water that is microbiologically unsafe or of unknown quality without adequate disinfection before or after the system.

Cascade Warranty

This Limited Warranty extends to the original purchaser of the system only. This warranty covers all Manufacturer-supplied items only that prove to be defective in material, workmanship or factory preparation. This warranty covers parts only; all labor is excluded from this warranty, including, but not limited to, services related to the removal, replacement, installation, adjustment, maintenance and/or repair of the unit or its components items. excludes all non-Manufacturer labor required for any servicing of the unit, including, but not limited to, servicing related to installation, adjustment, maintenance and repair of the unit. This warranty applies only for the first full calendar year from date of purchase. The following items are excluded from this warranty: membranes, filters, O-rings, and all other parts or components that require regular replacement as a result of ordinary usage.

Disclaimers: This Limited Warranty applies only if the system is installed, used and maintained in compliance with all instructions and requirements enclosed with the system. This warranty will be void for failure to observe the following conditions:

1. The system is to be used with potable water from a municipal water system.
2. Feed water pressure to the unit is no less than 40 PSI and no greater than 80 PSI.
3. The system is to be used on water supplies with chlorine concentrations of 1.0 mg/L (ppm) or less.
4. Feed water temperature to the unit must be no less than 40°F and no more than 100°F.
5. Total dissolved solids in feed water must be less than 2,000 mg/L (ppm).
6. Feed water must have a pH between 4 and 8.
7. Turbidity must be less than 1.0 NTU.
8. SDI must be less than 5.
9. Feed water must be completely free of iron, manganese or hydrogen sulfide.

Do not use with water that is microbiologically unsafe or of unknown quality without adequate disinfection before or after the system.

The Manufacturer does not know the characteristics of your water supply. The quality of water supplies may vary seasonably or over a period of time. Your water usage may vary as well. Water characteristics can also change if the drinking water appliance is moved to a new location. The Manufacturer assumes no liability for the determination of the proper equipment necessary to meet your requirements, and we do not authorize others to assume such obligation on our behalf.

This Limited Warranty does not cover any Manufacturer-supplied items that are defective as a result of the use of improper parts, equipment or materials. This warranty does not cover alterations or modifications of the unit, or failure of a unit caused by such alterations and modifications

This Limited Warranty does not cover malfunctions of the unit due to tampering, misuse, alteration, lack of regular maintenance, misapplication, fouling due to hydrogen sulfide, manganese or iron, scaling from excessive hardness, turbidity greater than 1.0 NTU, Silt Density Index (SDI) greater than 5.0 SDI, or excessive membrane hydrolysis due to chlorine levels in excess of 1.0 mg/L (ppm). In addition, damage to the unit due to fire, accident, negligence, act of God, or events beyond the control of the Manufacturer are not covered by this warranty.

Incidental and Consequential Damages Limitation: The Manufacturer will not be responsible for any incidental or consequential damages as a result of the failure of this unit to comply with express or implied warranties or any defect in the unit, including but not limited to, lost time, inconvenience, damage to personal property, loss of revenue, commercial losses, postage, travel, telephone expenditures, or other losses of this nature. Some states do not allow the exclusion or limitation of incidental or consequential damages, so this exclusion may not apply to you.

Owner's Warranty Responsibilities: As a condition of this Limited Warranty, the owner must ensure periodic maintenance of the system is performed as described in the literature enclosed with the system. Neglect, improper maintenance, abuse, modification or alteration of the unit will invalidate this Warranty. Should your unit develop a defect or otherwise fail to perform in accordance with this warranty, you should contact the retailer from whom the product was originally purchased.

Implied Warranties: The implied at-law warranties of merchantability and fitness for a particular purpose shall terminate on the date one year after the date of purchase. Note: some states do not allow limitations on how long an implied warranty lasts, so the above limitations may not apply to you.

Other Rights: This Warranty gives you specific legal rights and you may also have other rights which vary from state to state.

Cascade Typical Installation Diagram

The following instructions outline a typical water treatment system installation. Consult local plumbing codes and building regulations as they may pose different or additional requirements for the installation. The installer is responsible for ensuring that the installation is in compliance with all applicable state and local regulations.

This system has been designed for installation by a licensed professional such as a contractor or plumber. Proper completion of this installation will require basic familiarity with standard sink plumbing and proper use of common hand and power tools. Improperly installed systems could result in water damage due to leaks or flooding.

The connection parts kit supplied with the Cascade Drinking Water Filtration System includes components which represent the most common under-sink plumbing connections currently in use within the United States. If these components do not match the type of connections installed at your location, contact a local hardware or plumbing supplier to obtain the correct fittings.

Do not use with water that is microbiologically unsafe or of unknown quality without adequate disinfection before or after the system.

Typical Installation Diagram

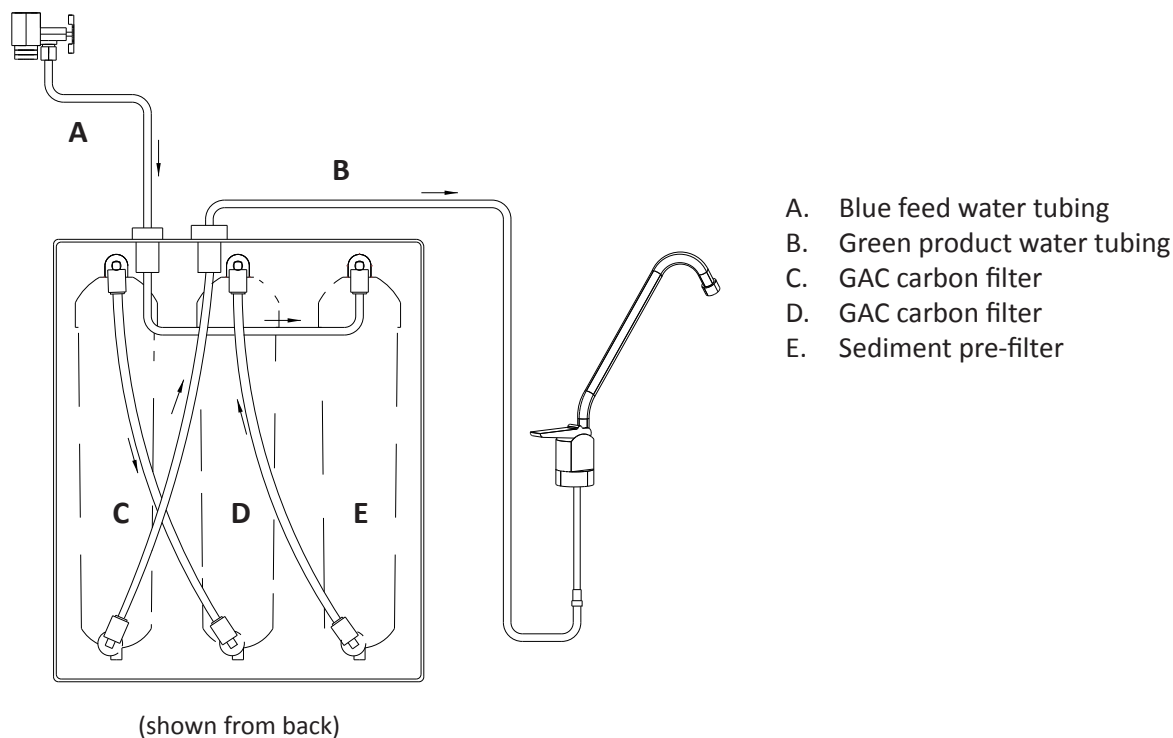

Cascade Feed Connection

1. Locate and turn off the angle stop valve on the cold water line feeding the sink. This valve will usually be located under the sink on the pipe coming out of the wall.
2. When the angle stop valve is closed, relieve pressure in the line by opening the cold water tap on the sink.
3. Disconnect the feed line at the angle stop valve.
4. If you have a push-to-connect feed connector, install the feed adapter into the angle stop. Firmly press the green 1/4" tubing into the 1/4" connector.

-OR-

Using the green 1/4" tubing, install the compression nut, plastic ferrule and plastic tube insert. Secure the tubing into the feed connector. Tighten the tubing retaining nut securely.

5. Connect the cold water faucet feed line to the feed adapter.
7. Attach the small Feed Valve Warning Tag from the parts bag to the feed valve.
8. Attach the Shutoff Warning label to the system so that it is directly visible. Fill out the Date Of Installation label and attach to the side of the system.

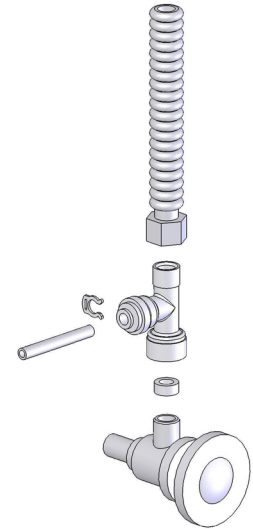

Cascade Faucet Installation

Determine the most practical under-the-sink location for placement of the Cascade system. Ensure that the location allows adequate access for cartridge replacement.

The faucet installation instructions below are for a standard non-airgap faucet with a quick-connection fitting. Your faucet installation may vary.

1. Place the system in the selected location.
2. Place the metal base plate and rubber seal flush against the base of the faucet.
3. Loosely thread the 3/8" washer (2), serrated washer (3) and mounting lock nut (4) onto the threaded stem.
5. Thread faucet quick-connect adapter (5) onto threads of faucet stem. NOTE: This connection should be hand-tightened only. Push end of 3/8" blue tubing (located on the system) up through the hole in the sink. Press into open end of adapter.
6. Push the faucet base assembly down through the sink hole.
7. Position the faucet to the desired handle orientation. Slip the (1) slotted washer between the rubber seal and the sink. Securely hand tighten the mounting nut.
8. Firmly insert spout assembly into the top hole of faucet body (approximately 1/4"). You may swivel the faucet left or right.

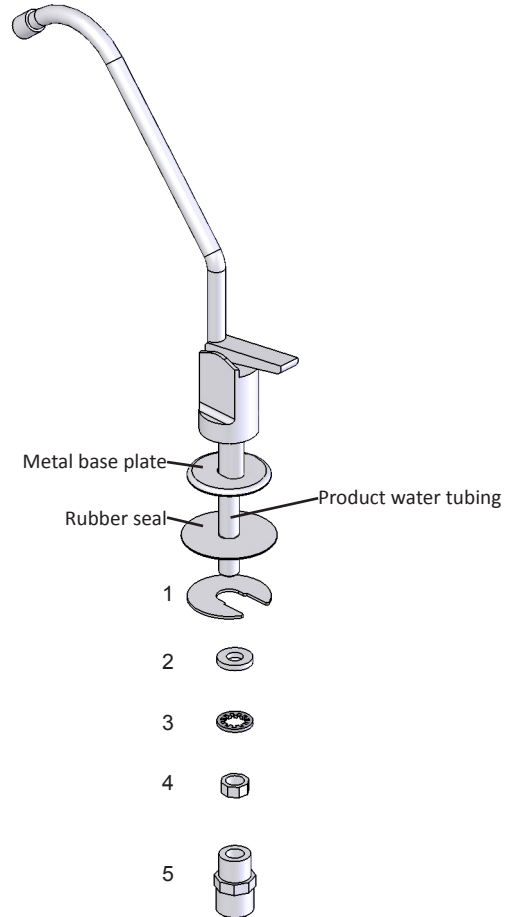

Cascade Manifold Installation

Determine the most practical under-the-sink location for placement of the Cascade manifold unit. Ensure that the specific location allows adequate access to the manifold unit for cartridge replacement.

1. Place the manifold in the selected location. If desired, the #6 self tapping screws may be used to secure the manifold unit in position by means of the top rear and bottom lip mounting holes.
2. Route the blue tubing from the faucet assembly to the blue coded connector, marked Feed, on the top of the manifold unit.
3. Take the green tubing already connected to the water feed valve and insert it into the green coded connector. Push the tubing approximately 1/2" into the connector until fully seated.
4. Affix Shutoff Warning to the manifold unit so that it is directly visible in the event that a cartridge is to be replaced. The Cascade Drinking Water Filtration system is now connected and ready for system activation.

TUBING HINTS: Use a sharp knife or tubing cutter to cut the tubing squarely, being sure to remove all burrs. Then insert the tubing firmly until it stops. To remove the tubing, push against the collet while pulling on the tubing.

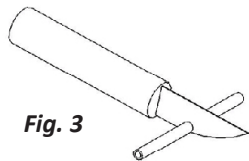

Fig. 3

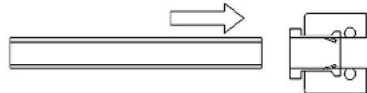

Fig. 4

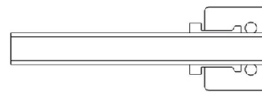

Fig. 5

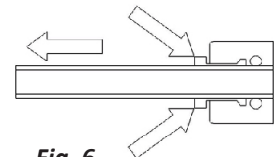

Fig. 6

Cascade System Activation and Checklist

System Activation and Inspection

1. Check all tubing connections to ensure they are firmly seated. CHECK TO SEE THAT THE CARTRIDGE RETAINER CLIPS ARE PROPERLY INSTALLED WITH SLIDE LOCKS FULLY ENGAGED IN FRAME SLOTS. The retainer clips must be in place during long term, unattended operation of the system. Failure to keep the retaining clips in place could result in accidental leaks and flooding.
2. Open the dispensing faucet at the sink. Open the feed water valve to the system. Observe all tubing and connections for several minutes to detect any leaks. Allow the faucet to run for at least 3 minutes, then close the faucet. A small amount of carbon fines may be seen in the initial flushing of the system.
4. Check fittings again for leaks after closing the faucet.

Checklist

1. Cascade unit is located where it will not be subject to physical impacts or rough contact by heavy objects.
2. Feed water pressure to the unit is no less than 40 psi and no greater than 100 PSI.
3. All cartridge plastic retainer clips are installed properly.
4. All tubing connections, especially push-in quick connections, are fully inserted.
5. Feed valve is open.

Cascade Maintenance

Cartridge Replacement

1. Close the feed water shut-off valve.
2. Open the dispensing faucet.
3. Pull the manifold unit from the installed location.
4. Remove the retaining clip at the front of the unit by pulling back the slide lock and squeezing and pulling to remove. Pull the cartridge off the manifold evenly at top and bottom. Dispose of used cartridge.
5. Install the new cartridge, rocking gently from side to side as necessary until the cartridge tubes are properly engaged in the manifold connectors. Install the retaining clip ensuring the slide locks snap into place in the slots. If the clip does not snap easily into place through the slots it means the cartridge is not fully inserted into the connectors. Press top or bottom of cartridge to engage connectors until it snaps into place properly.
6. Close the dispensing faucet. Turn on feed water valve. Observe system for any leaks, especially at newly replaced cartridge.
7. If the replaced cartridge was a carbon filter, open the dispensing faucet and let water run for at least 3 minutes to flush out any carbon fines.

